



SWING CHECK VALVE CHF-114



Application	: For water, Natural Liquids and Sewage
Working Pressure	: 16 Bar .
Drilling	: DIN 2501 , ISO 2531.
Ductile Iron	: DIN EN 1563
Face To Face	: BS 5153
Coating	: Epoxy 200-300 Mic.
Ductile Iron	: DIN EN 1563 / ASTM 536A.
SS 304	: ASTM 582A.
Hydrotesting	: DIN 3230
Feature	: anti slam valve with counter weight.

Design Mechanical Data, Dimension , Materials and weight are subject to change without notice



SWING CHECK VALVE CHF-114

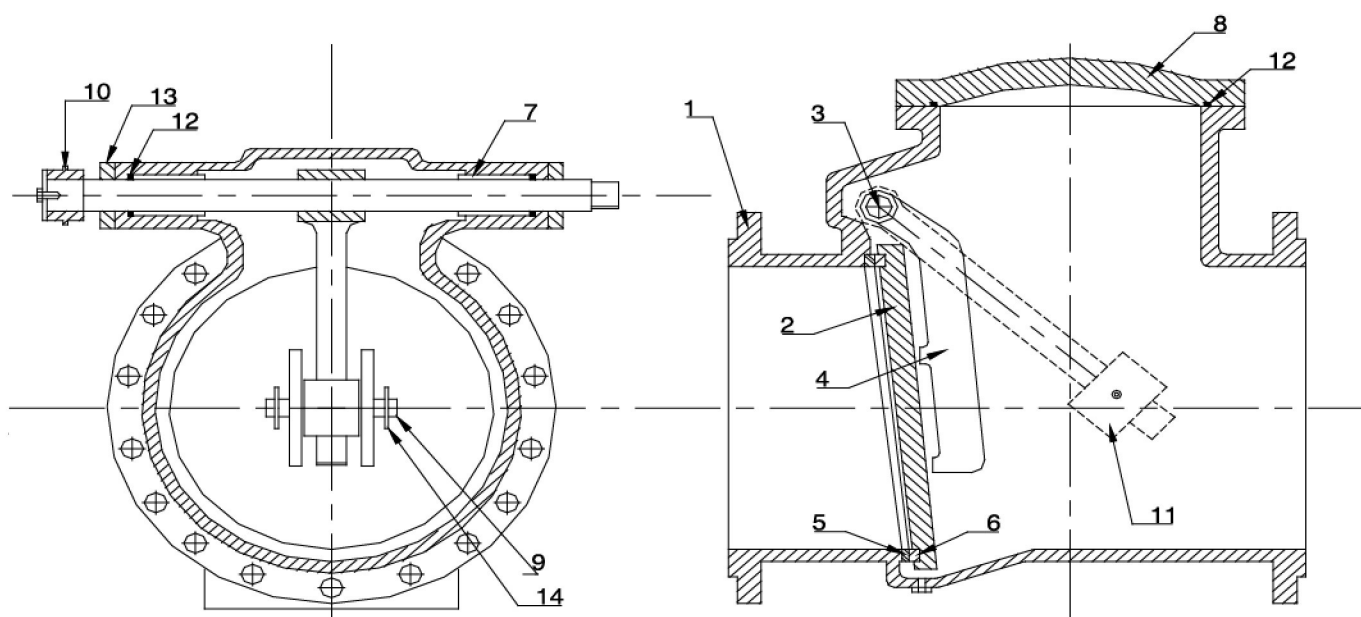

MATERIAL LIST

Part	Description	Material
1	Body	Ductile Iron GGG 50/40
2	Disc	Ductile Iron GGG 50/40
3	Shaft	St. St. SS304/ 316
4	Rocker Arm	Ductile Iron GGG 50/40
5	Body Seat	SS304 / Rg5 Bronze
6	Disc Seat	SS304 / Rg5 Bronze
7	Bearing	Rg5 Bronze
8	Cover	Ductile Iron GGG 50/40
9	Hinge Pin	X20Cr13 St. St. / SS304
10	Lever	St-37 Steel
11	Weight	Ductile Iron GGG 50/40
12	O-Ring	EPDM Rubber
13	Shaft Cover	Ductile Iron GGG 50/40
14	Split Pins	SS304/ 316

Standard	DN	100	150	200	250	300	350	400
BS5153	L	292	356	495	622	698	787	914

Standard	DN	100	150	200	250	300	350	400	450	500	600	700	800	900
BS EN558:2008 Series 10	L	292	356	495	622	698	787	914	978	978	1295	1448	1676	1956

Design Mechanical Data, Dimension , Materials and weight are subject to change without notice